



STL
ALUMÍNIO

LINHA

DISSIPADORES

PERFIL EXTRUDADO DE ALUMÍNIO

CATÁLOGO Ver 1.0 | DEZ 24

PERFIL	MERCADO	KG/M	PÁG.
STL-0031	—	3,178	05
STL-0032	—	1,121	03
STL-0080	—	1,375	04
STL-0131	—	0,452	06
STL-0191	—	1,622	04
STL-1391	—	4,825	05
STL-1676	—	0,826	06
STL-1677	—	1,208	04

STL-0032

Merc. -----

Peso 1,122 kg/m

Descr. -----

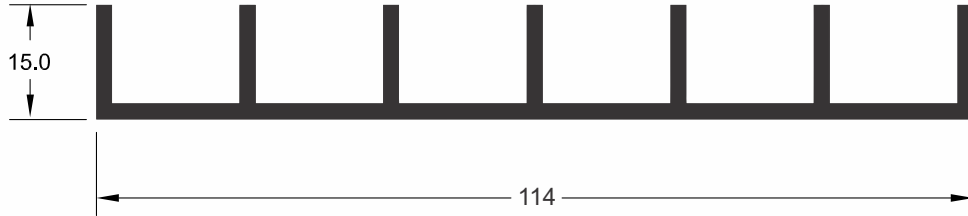

STL-1677

Merc. -----

Peso 1,208 kg/m

Descr. -----

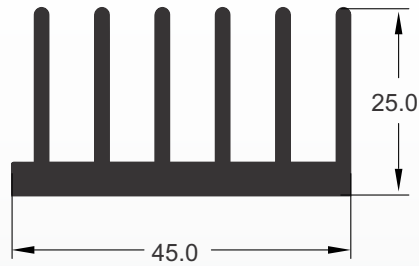

STL-0191

Merc. -----

Peso 1,622 kg/m

Descr. -----

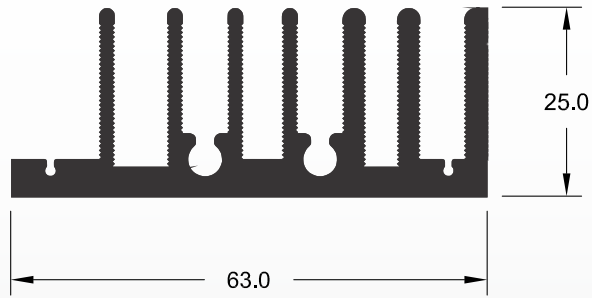

STL-0080

Merc. -----

Peso 1,375 kg/m

Descr. -----

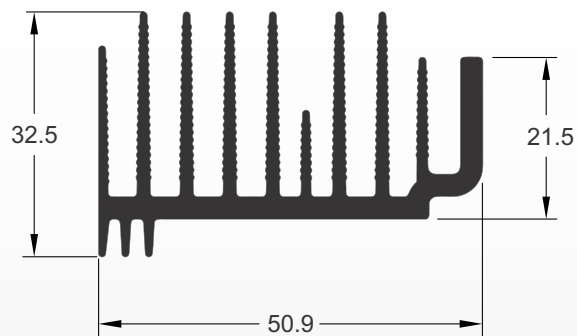

STL-0031

Merc. -----

Peso 3,178 kg/m

Descr. -----

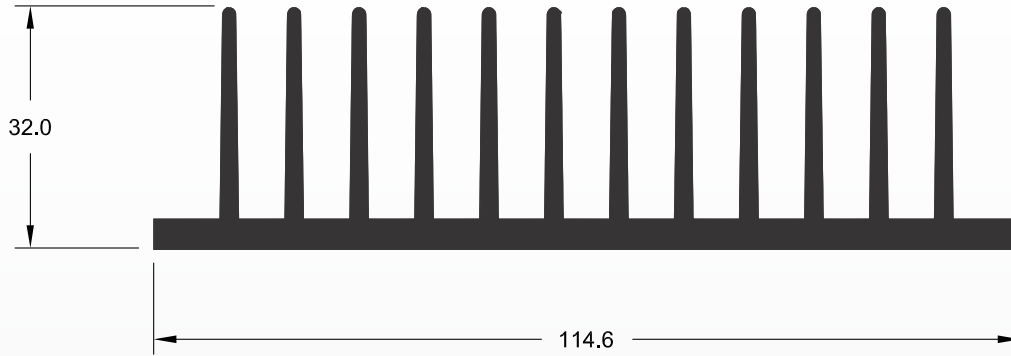

STL-1391

Merc. -----

Peso 4,825 kg/m

Descr. -----

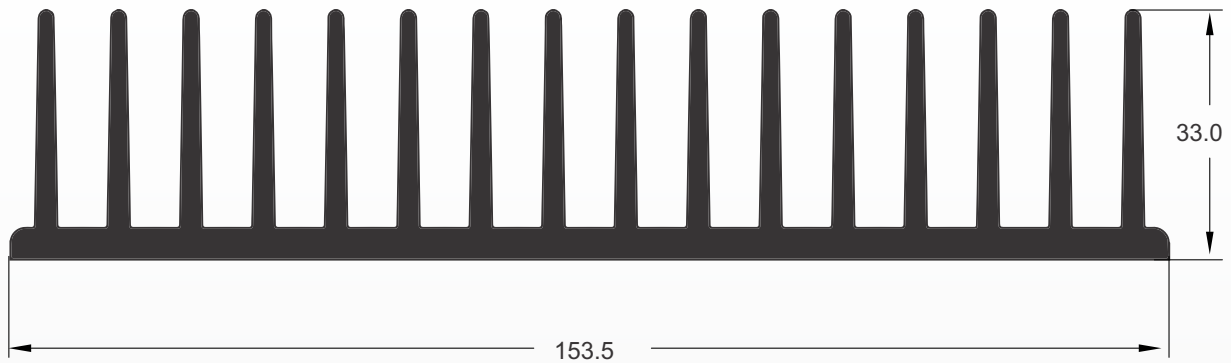

STL-0131

Merc. -----

Peso 0,452 kg/m

Descr. -----

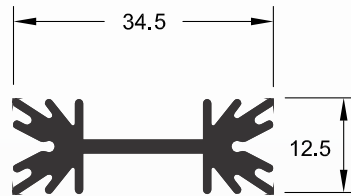

STL-1676

Merc. -----

Peso 0,826 kg/m

Descr. -----

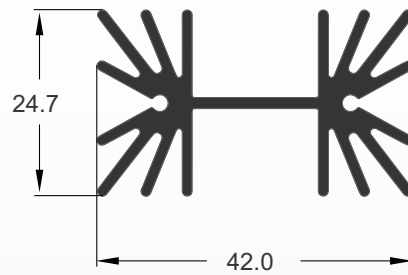



STL
ALUMÍNIO



stlaluminio.com.br



Av. Industrial, 1500 - Distrito Industrial - CEP 08586-150
Itaquaquecetuba - SP - Tel.: 55+ 11 4233-9012